

Wireless Door/Window Contact

DWC-100

Operation Manual



Features

The DWC-100 is a Door/Window Contact that can be installed on doors, windows, and any other objects that open and close. The sensor transmits signals to the control panel when a magnet mounted near the sensor is moved away. External input for wired accessory is available at the N/C interface. The tamper protection ensures that sabotage attempts to move the contact will result in an alarm activation.

Appearance

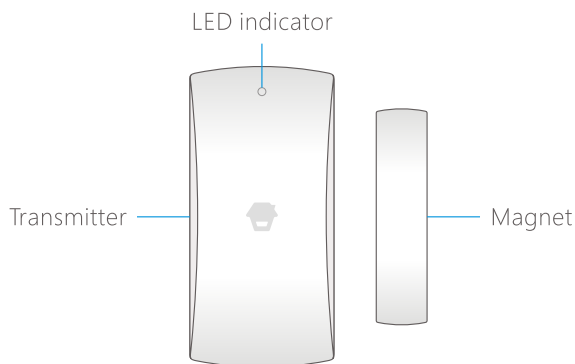

Specifications

Power supply	DC 1.5V (AA 1.5V LR6 Battery x 1pc)		
Static current	≤ 30uA	Alarm current	≤ 40mA
Transmitting distance	≤80m (in open area)		
Radio frequency	315MHz/433MHz (±75KHz)		
Housing material	ABS plastic		
Operating temperature	-10°C~55°C		
Relative humidity	≤80% (non-condensing)		
Transmitter dimensions (LxWxH)	71 x 34 x 17.5mm		
Magnet dimensions (LxWxH)	51 x 12 x 13.5mm		

PCB Layout

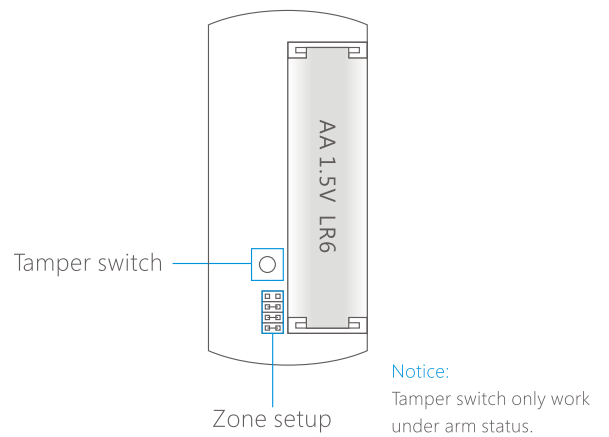

LED Indication

LED flashes once: Door/window is opened and transmitter sends signal to the control panel.

LED flashes quickly when triggered: Low power indication, please change battery as soon as possible.

Installation & Notice

- Open the case and remove the battery activation strip.
- Mount the sensor on the door frame and the magnet on the door.
- Make sure the magnet is on the right side of the transmitter
- Place the transmitter in the desired location, mount the magnet no more than 1cm away from the transmitter and secure the transmitter and magnet with double-sided tapes or screws.
- Avoid mounting sensors in areas with a large quantity of metal or electrical wiring, such as a furnace or utility room.

