

ZGI7034W The Most Durable CCTV Camera

30M Outdoor Color IR Camera

iNNEKT
Innovative Technology

- 960H SONY Double Scan Super HAD CCD II
- Super Wide Dynamic Range by SONY Effio-P
- Stylish aluminum alloy housing for outdoor
- Wide input voltage (DC 9-20V)
- User - friendly line Control OSD menu
- Fixed iris board lens 4.0mm
- 1PC x Super IR Array LED. Up to 30M range
- Constant current circuit for long life IR LED
- IP67 Waterproof with outstanding durability
- Internal cable wiring with 3 axis bracket



Dimensions (unit : mm)

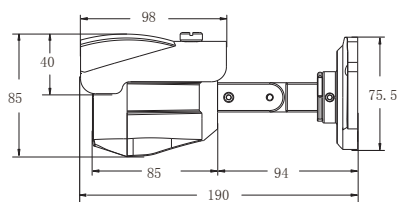

Side View

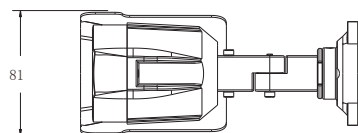

Bottom View

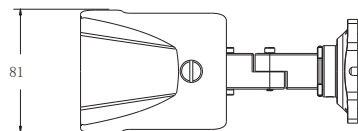

Top View

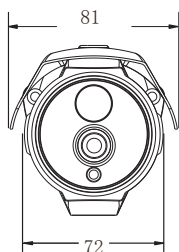

Front View

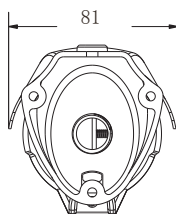

Rear View

Specification

Model	ZGI7034W	
Signal System	PAL	
Image Sensor	1/3" 960H Sony Double Scan Super HAD CCD II	
Scanning System	2:1 Interlaced	
Scanning Frequency	H: 15.625 KHz, V: 50 Hz	
Total Pixels	1028(H) x 596(V)	
Effective Pixels	976(H) x 582(V)	
Resolution	700 TV Lines	
ESC	Electronic Auto Shutter	1/50 - 1/100,000 sec automatic
	Manual Shutter	1/53, 1/120, 1/250, 1/500, 1/1000, 1/2000, 1/4000, 1/10000
S/N ratio	More than 50 dB (AGC Off)	
Sensitivity	0 Lux (IR LED On)	
Gamma correction	r = 0.45	
Synchronize System	Internal	
Video Output	1 Vp-p 75 ohm Composite	
OSD Control	Joystick (Line Control)	
Multiple Language OSD	English, Japanese, Chinese	
EZOOM	Picture Magnification (x255), Pan/Tilt (Must magnify the picture first)	
Back Light Compensation	Off, BLC, HLC	
White balance	ATW	Auto.1800°K - 10500°K
	Selectable	ATW, Push, User1, User2, Anti-CR, Manual, Push Lock
Wide Dynamic Range	FULL, Normal, Light (Adjustable by control Contrast Level)	
3D Noise Reduction	OFF, LOW, MIDLOW, MID, MIDHIGH, HIGH	
Day / Night	ICR Moving Filter Mechanism (optional)	
Motion Detection	4 Zones	
Privacy Masking	Upto 15 Zones	
Digital Effects	Mirror / Contrast / Sharpness etc	
Lens	f4.0mm Fixed Iris Lens	
IR LED	1PC x Super IR Array LED, Up to 30M Range	
IR LED Operation	On (1Lux) / Off (1Lux)	
IP Rating	IP67 Waterproof	
Power Supply	DC12V (Tolerance DC9~20V)	
Operating current	400mA w/regulated power in	
Operating Temperature	14°F ~ 122°F (-10°C ~ +50°C)	
Storage Temperature	-4°F ~ 140°F (-20°C ~ +60°C)	
Dimension(mm)	190(L) x 81(W) x 85(H)	
Weight(Approx.g)	680g	

FC RoHS CE